

EMERGENCY PREPAREDNESS KEY - Pete Palangio Arena

FIRST IDENTIFY THE EMERGENCY

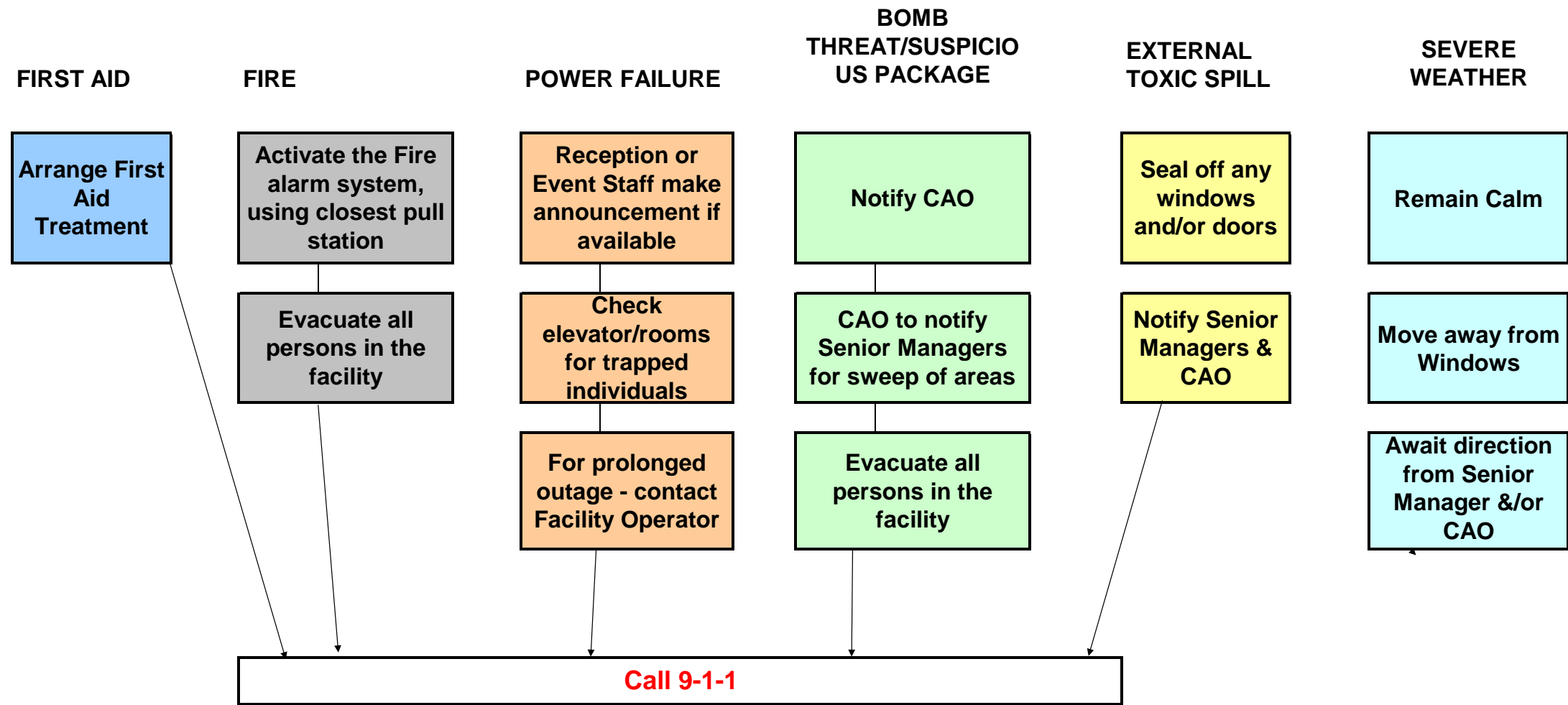

Notify 9-1-1 of the following:

1. The nature of the emergency (medical, gas leak, etc.)
2. Location of the emergency
3. Prepare to answer general questions as to the condition of the circumstance and/or the person(s) involved.

Have someone available to direct emergency response personnel to the scene.

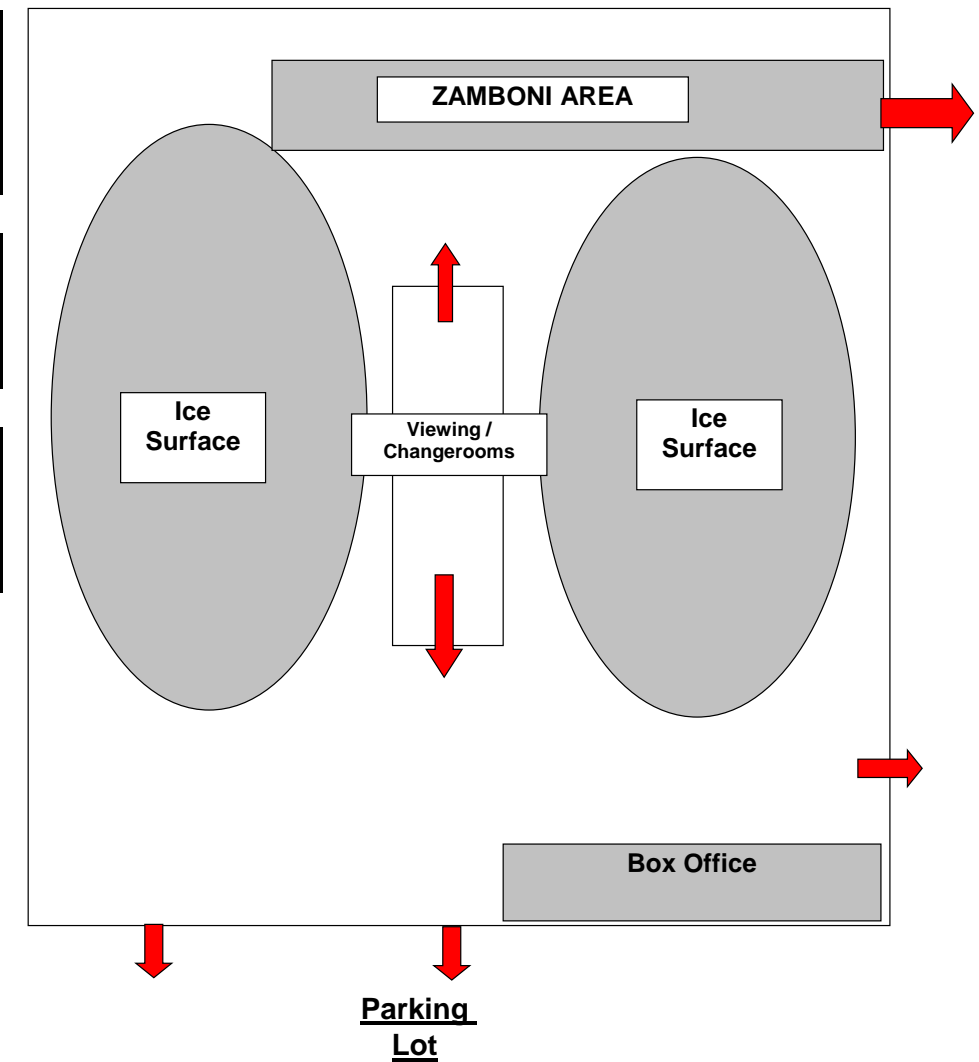

If you require further assistance, please contact an onsite staff member.

****This plan is intended to assist employees and visitors working and interacting at our public facilities in cases of identified emergencies.